

Plans and drawings relevant to reports submitted to Eastern Area Planning Committee

Wednesday 9th April 2025 at 6.30pm

**At Council Chamber, Council Offices, Market Street,
Newbury, RG14 5LD**

&

And via Zoom

[to be read in conjunction with the main agenda]

Please note:

- *All drawings are copied at A4 and consequently are not scalable*
- *Most relevant plans have been included – however, in some cases, it may be necessary for the case officer to make a selection*
- *All drawings are available to view at www.westberks.gov.uk*



WestBerkshire
C O U N C I L

24/02658/FULMAJ
Thatcham Memorial Playing Fields
Brownsfield Road
Thatcham

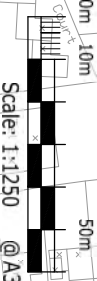
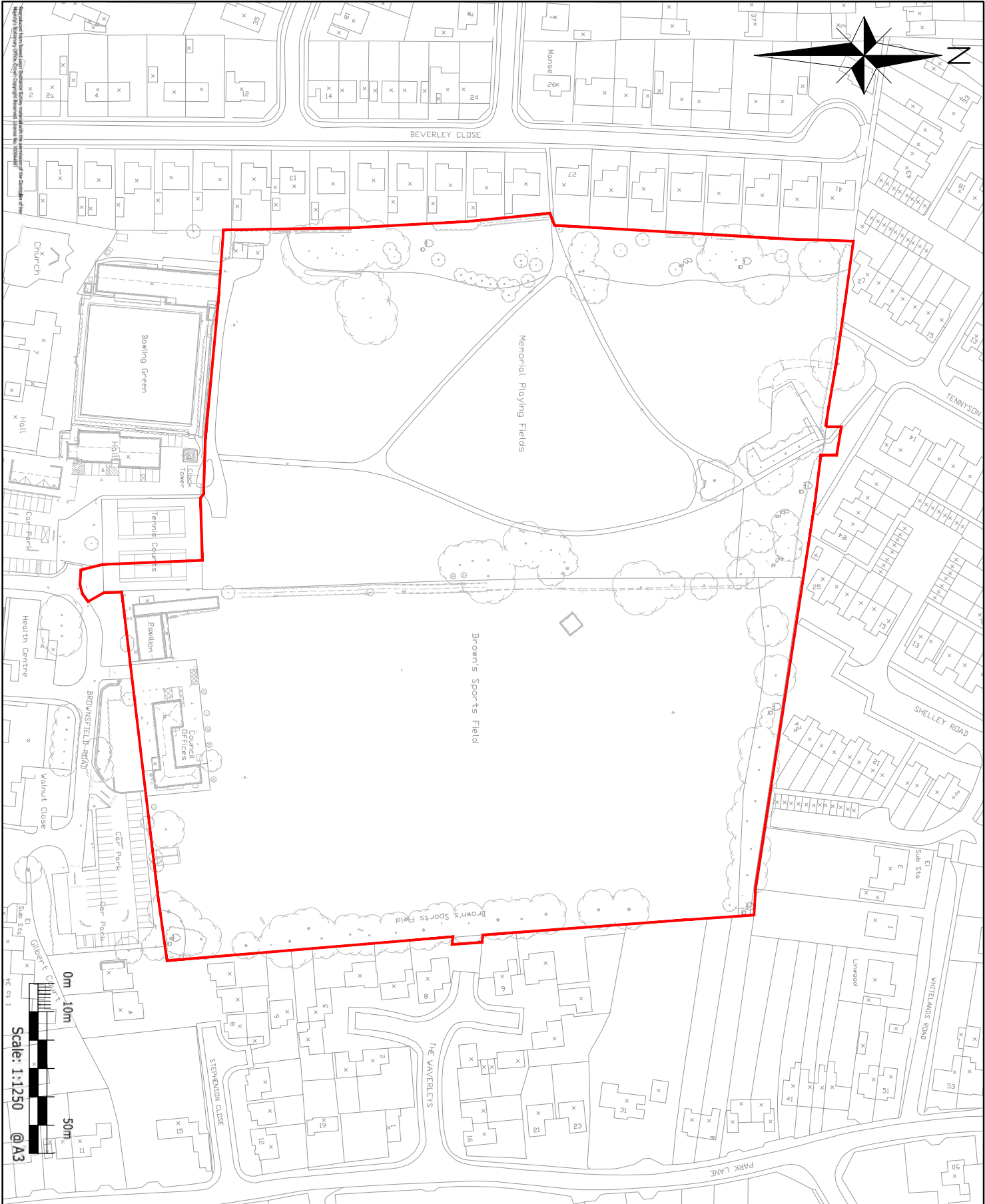

KEY

PROPOSED SITE RED LINE BOUNDARY
AREA - 5.6 HECTARES

NOT FOR
CONSTRUCTION

PLANNING ISSUE

DATE BOUNDARY UPDATED	DATE	BY	DATE
DATE BOUNDARY UPDATED	DATE	BY	DATE
DATE BOUNDARY UPDATED	DATE	BY	DATE

ARDENT CONSULTING ENGINEERS

Third Floor
The Helix Building
125 Abchurch Lane
London EC4N 3SE
EC4N 3SE
Tel: 020 7660 4088
Web: www.ardent-ec.co.uk
E-mail: enquiries@ardent-ec.co.uk



WEST BERKSHIRE COUNCIL

MEMORIAL FIELDS
FLOOD ALEVIATION SCHEME

SITE LOCATION PLAN

AS Scale	Date	Designed by
1:1250	SEPT 2023	ME
Drawn by	Checked by	Approved by
ME	BW	BC
Drawing Number	2004241-016	Rev
		P2

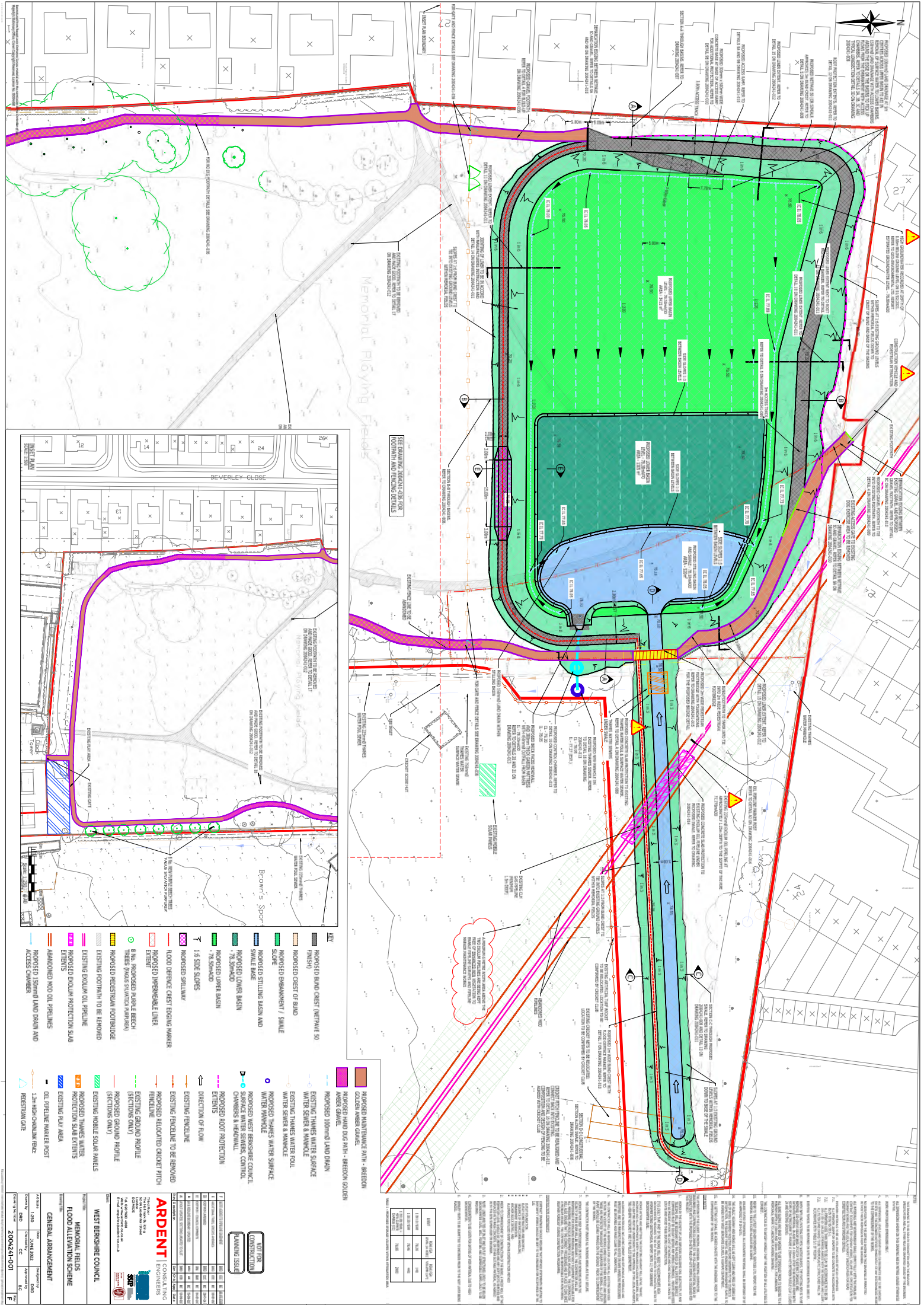
[illegible]

